

Legend

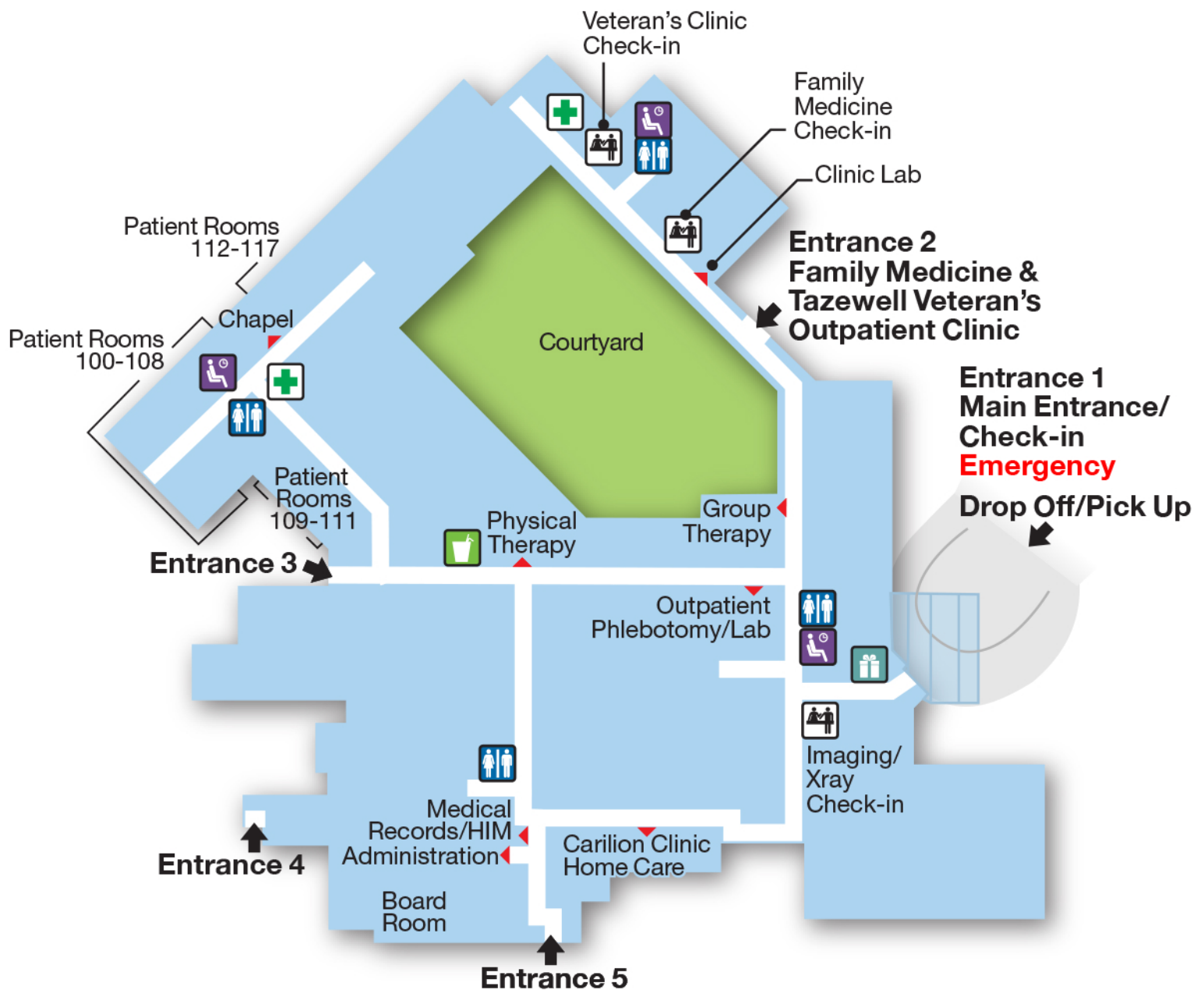

Areas of Interest

Administration	Medical Records/HIM
Board Room	Outpatient Phlebotomy/Lab
Carilion Clinic Home Care	Patient Rooms 100-117
Chapel	Physical Therapy
Family Medicine Check-in (Entrance 2)	Veteran's Clinic Check-in (Entrance 2)
Group Therapy	Clinic Lab (Entrance 2)
Imaging/Xray Check-in	



CARILION

TAZEWELL COMMUNITY HOSPITAL

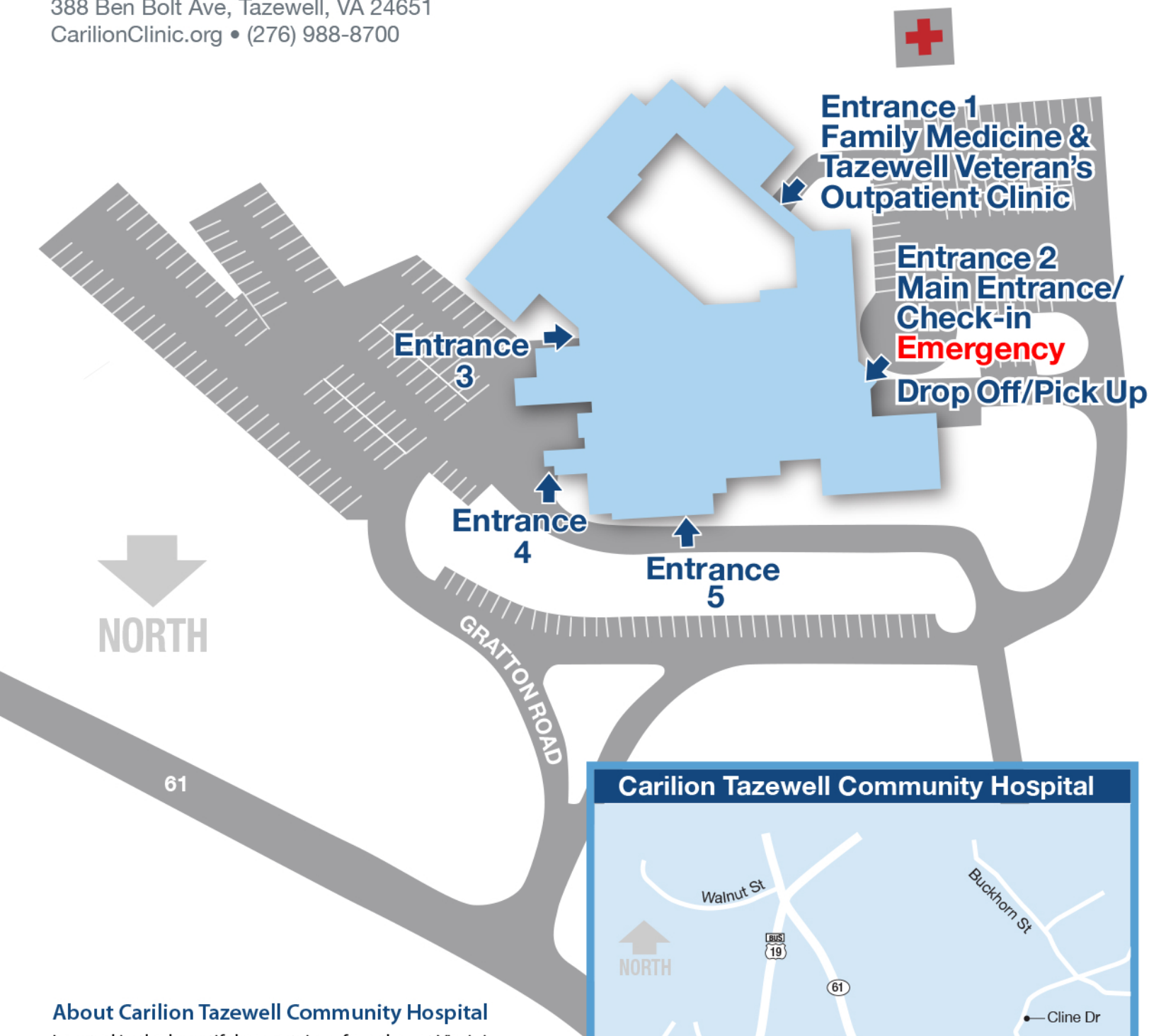

About Carilion Tazewell Community Hospital

Located in the beautiful mountains of southwest Virginia, Carilion Tazewell Community Hospital (CTCH) has 15 medical care rooms and is equipped to take care of patients needing step-down recovery services known as the "swing bed" program.

CTCH has a 24/7 emergency department and as a part of the Carilion Clinic family of hospitals, the team is poised to access higher-levels of care, if needed. Within our facility, we host family medicine services and the Veterans Outpatient Clinic.

CTCH supports several types of diagnostic and rehabilitation services, such as advanced imaging, mammography, physical therapy and respiratory therapy. For outpatient follow-up, our hospitalists can facilitate patient appointments with specialties in and outside the Carilion network of services. We are a loyal community partner and dedicated to helping you on your wellness journey.



CARILION

TAZEWELL COMMUNITY HOSPITAL